

THE PINNACLE OF LUXURY LIVING!

SERVICE WITH A LIFESTYLE

Quality living Today, Everyday.



S3 Constructions Pvt Ltd

AMAN



S3 Constructions Pvt Ltd

presents

AMAN

2 and 3 BHK Apartments

BLOCK - A

Office Address :

#5, Kalaivanar Salai,
Chitlapakkam,
Chennai - 64

Specifications

STRUCTURE

- RCC Framed Structure
- Bricks, Solid Blocks, AAC Blocks

FLOOR FINISHES

- 4' x 2' Vitrified tiles for Living, Dining and Bedrooms
- 1' x 1' 6" Anti-Skid tiles for Bathroom
- Granite for Staircase

DOORS

- Teakwood frames and shutters for Main door
- ABS door for Bedrooms
- Water proof doors for bathrooms

WINDOWS

- UPVC Windows

SANITARY

- Jaquar or equivalent sanitary fittings

PAINTING

- Acrylic emulsion with putty finish for interiors
- Weather proof paint finish for exterior
- Varnish for main doors
- Enamel paint for window grills

ELECTRICAL

- Three phase electricity connection
- Metal switch boxes and modular switches
- Fire resistance cables

KITCHEN & HARDWARE

- Granite finish cooking slab with S/S sink
- Glazed ceramic tiles dado for 2' height



For Bookings :

044 4280 1177

97897 84999



THE FINEST IN LUXURIOUS LIVING



Location Map



Site Address :

#4C, Pambanswamigal Salai,
Chitlappakam,
Chennai - 600 064

SITE CUM STILT FLOOR

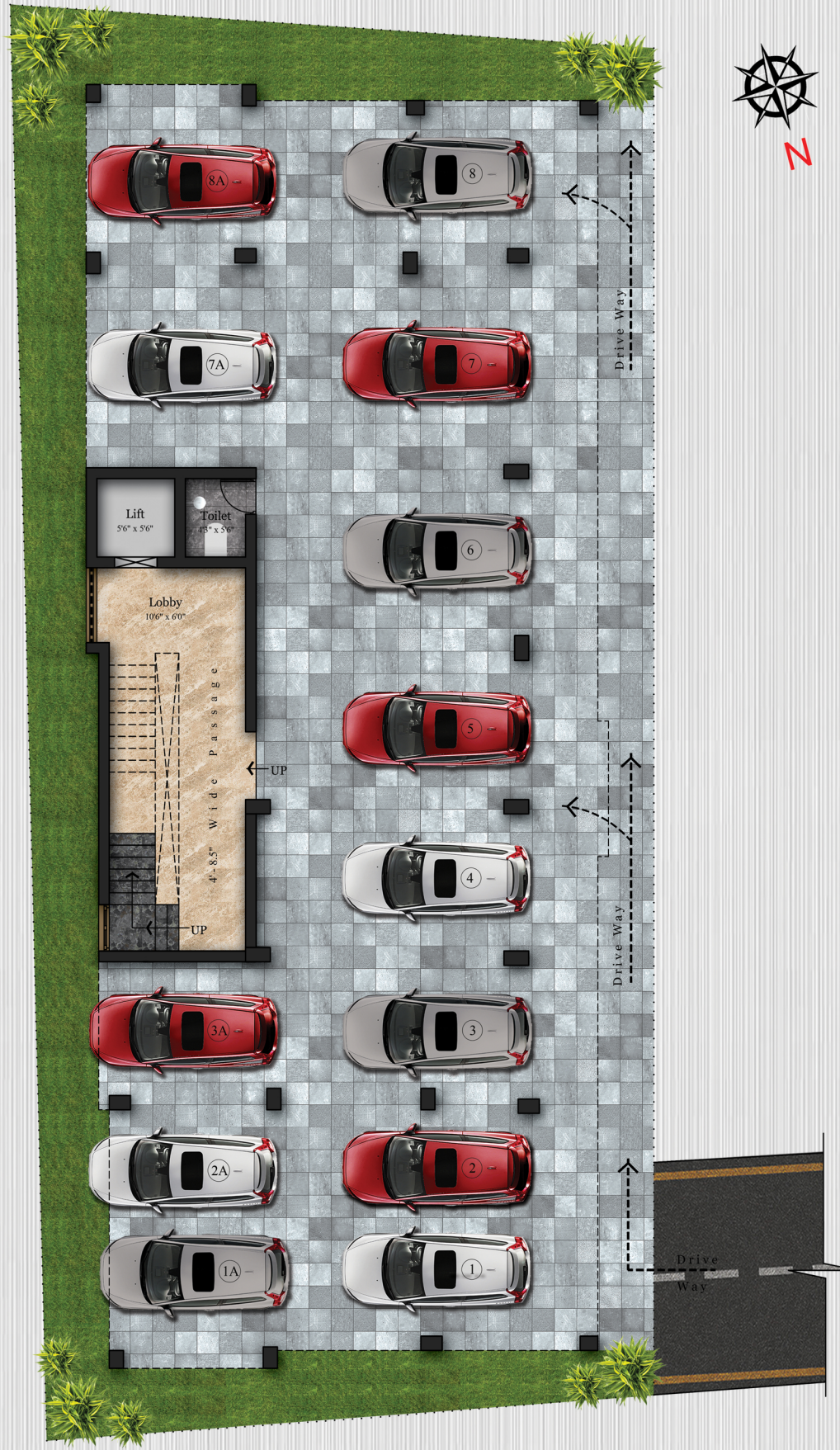

BLOCK - A



TYPICAL 1ST & 2ND FLOOR PLAN

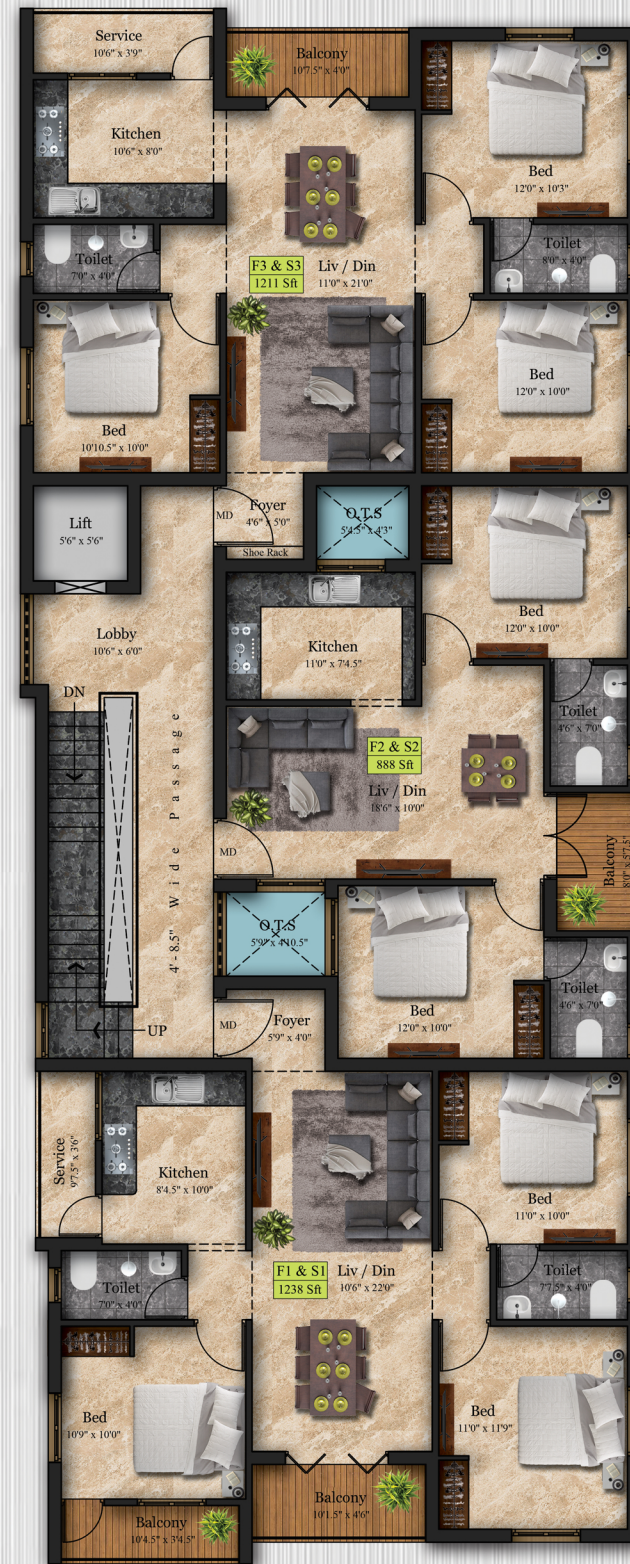

Flat	Plinth	Common	Total	UDS
F1	1015 Sft	223 Sft	1238 Sft	556.25 Sft
F2	728 Sft	160 Sft	888 Sft	399.00 Sft
F3	993 Sft	218 Sft	1211 Sft	544.00 Sft
S1	1015 Sft	223 Sft	1238 Sft	556.25 Sft
S2	728 Sft	160 Sft	888 Sft	399.00 Sft
S3	993 Sft	218 Sft	1211 Sft	544.00 Sft

THIRD FLOOR PLAN



Flat	Plinth	Common	Total	UDS
T1	1211 Sft	266 Sft	1477 Sft	663.50 Sft
T2	1171 Sft	258 Sft	1429 Sft	642.00 Sft